

## Aderendhülsen

0,08 mm<sup>2</sup> - 7 mm

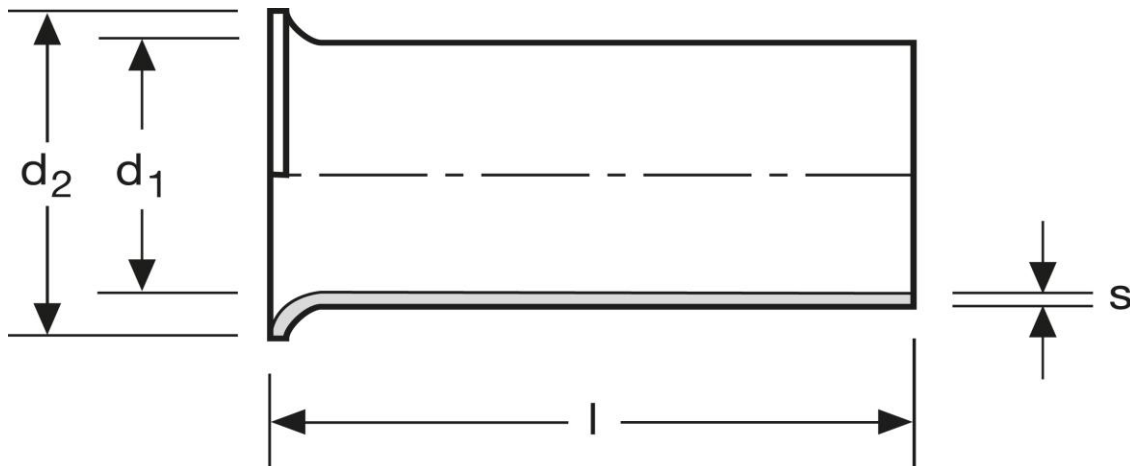

Art.Nr.	Werkstoff	Oberfläche		
A 101070	Cu-ETP	galv. Sn	0,033/1000	1.000
	<b>l</b>	<b>d<sub>1</sub></b>	<b>d<sub>2</sub></b>	<b>s</b>
<b>in mm:</b>	<b>7</b>	<b>0,5</b>	<b>1,2</b>	<b>0,15</b>

Stand: 01.12.2020

## Cord end-sleeves

0,08 mm<sup>2</sup> - 7 mm

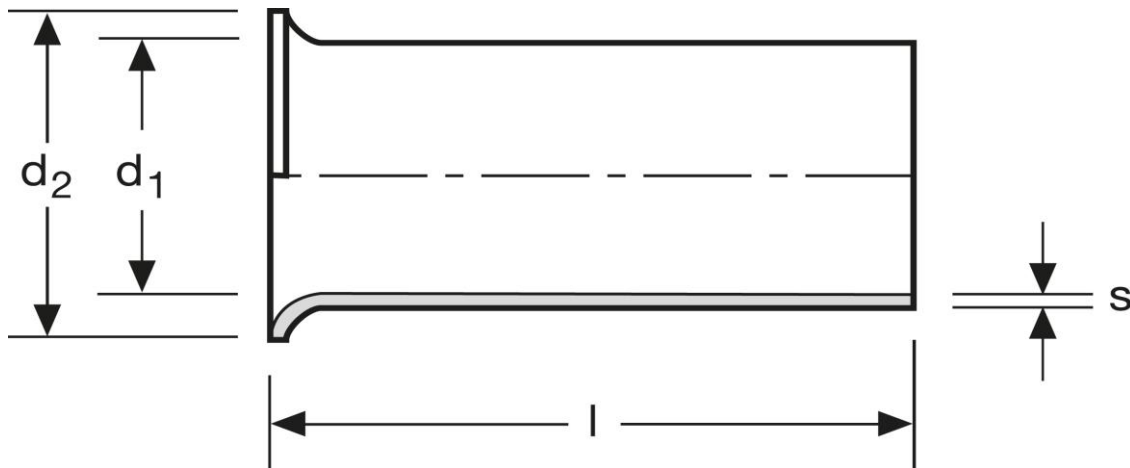

part no	material	surface		
A 101070	Cu-ETP	tin plated	0,033/1000	1.000
	<b>l</b>	<b>d<sub>1</sub></b>	<b>d<sub>2</sub></b>	<b>s</b>
<b>in mm:</b>	<b>7</b>	<b>0,5</b>	<b>1,2</b>	<b>0,15</b>

Date: 01.12.2020