

Aderendhülsen

0,14 mm² - 10 mm

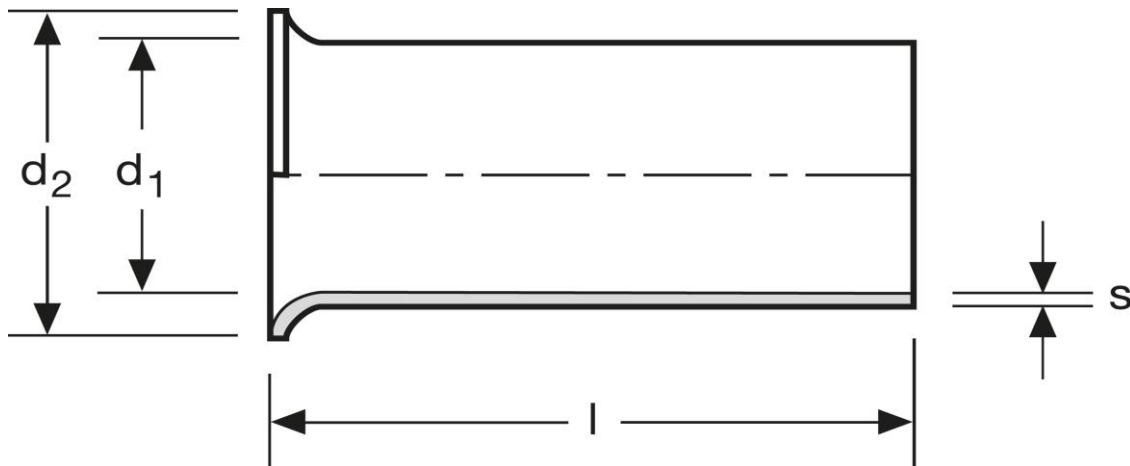

Art.Nr.	Werkstoff	Oberfläche		
A 102100	Cu-ETP	galv. Sn	0,049/1000	1.000
	l	d₁	d₂	s
in mm:	10	0,7	1,6	0,15

Stand: 03.01.2019

Cord end-sleeves

0,14 mm² - 10 mm

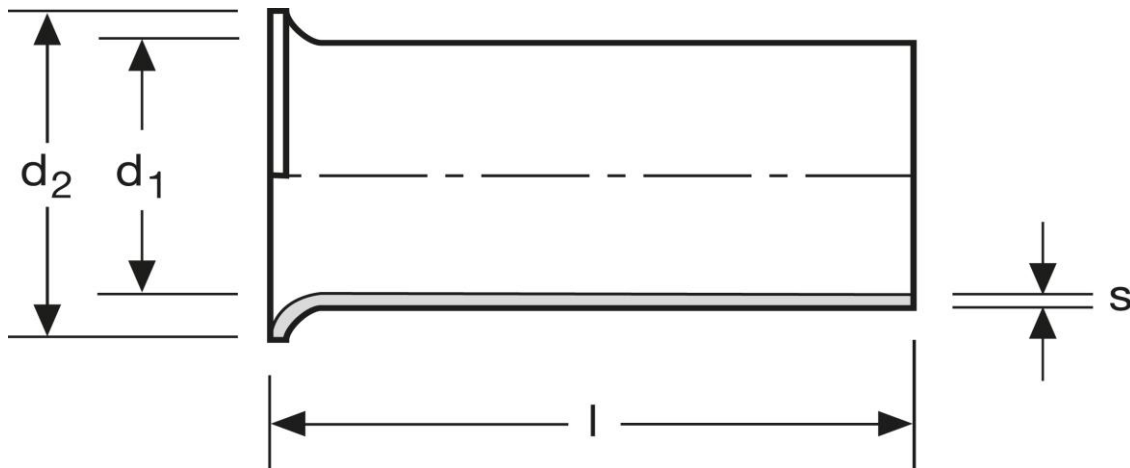

art.no.	material	surface		
A 102100	Cu-ETP	tin plated	0,049/1000	1.000
	l	d₁	d₂	s
in mm:	10	0,7	1,6	0,15

Date: 03.01.2019