

## Aderendhülsen 0,75 mm<sup>2</sup> - 8 mm

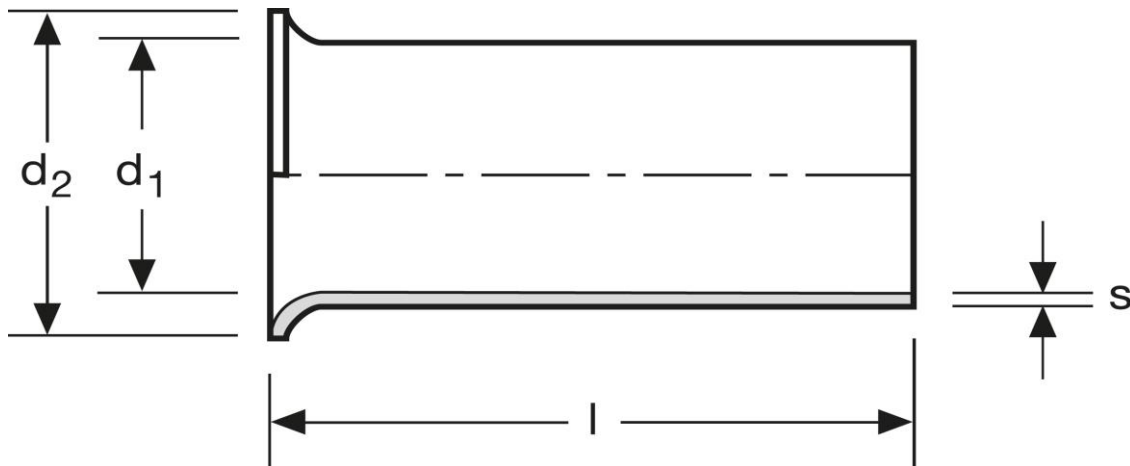

Art.Nr.	Werkstoff	Oberfläche		
A106080BL	Cu-ETP	keine	0,052/1000	1.000
	$l$	$d_1$	$d_2$	$s$
in mm:	8	1,3	2,3	0,15

Stand: 02.01.2018

## Cord end-sleeves 0,75 mm<sup>2</sup> - 8 mm

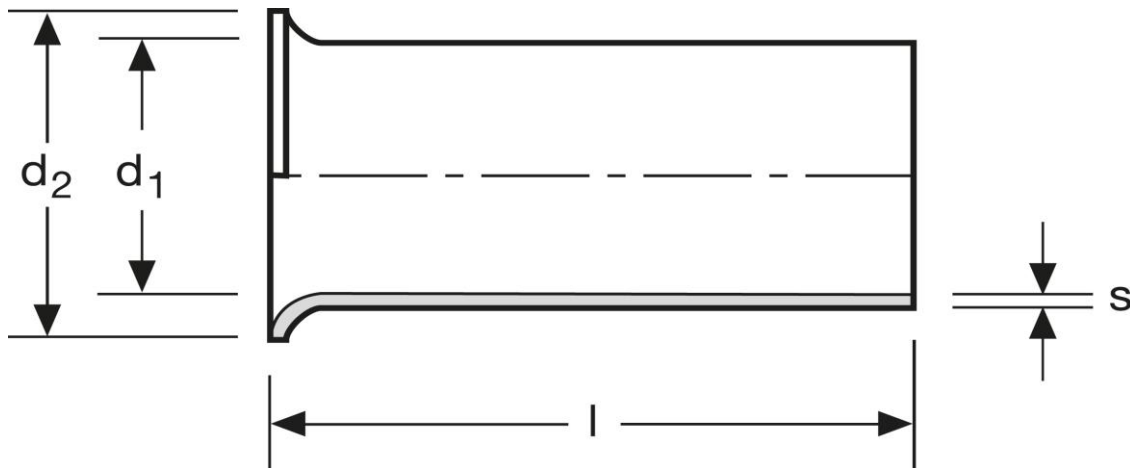

art.no.	material	surface		
A106080BL	Cu-ETP	none	0,052/1000	1.000
	$l$	$d_1$	$d_2$	$s$
in mm:	8	1,3	2,3	0,15

Date: 02.01.2018