

Aderendhülsen 2,5 mm² - 10 mm

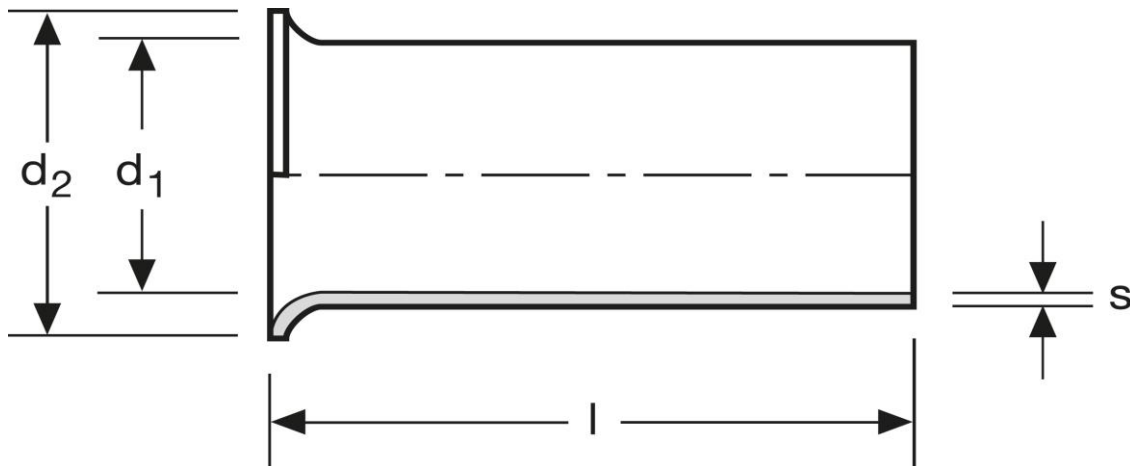

Art.Nr.	Werkstoff	Oberfläche		
A109100BL	Cu-ETP	keine	0,118/1000	1.000
	l	d ₁	d ₂	s
in mm:	10	2,3	3,4	0,15

Stand: 02.01.2018

Cord end-sleeves 2,5 mm² - 10 mm

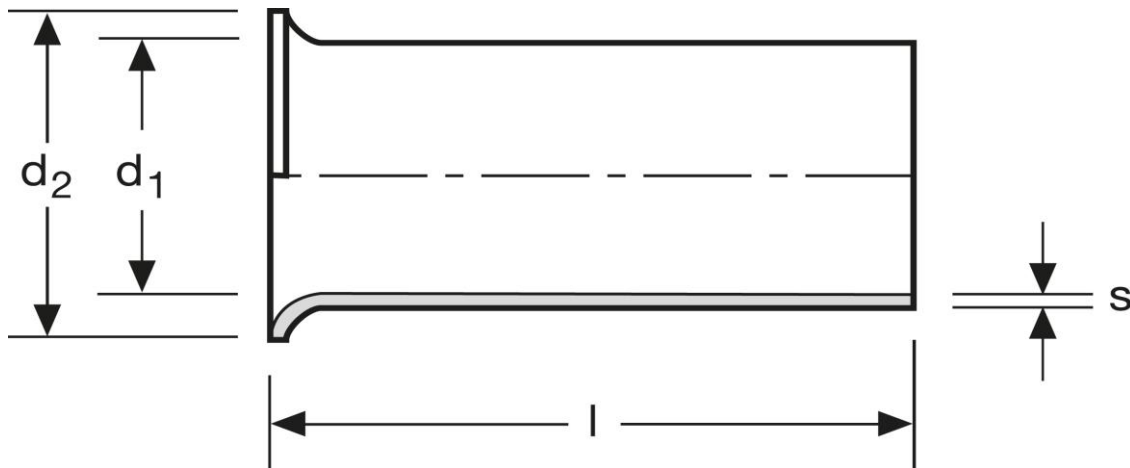

art.no.	material	surface		
A109100BL	Cu-ETP	none	0,118/1000	1.000
	l	d ₁	d ₂	s
in mm:	10	2,3	3,4	0,15

Date: 02.01.2018