

Aderendhülsen 6 mm² - 12 mm

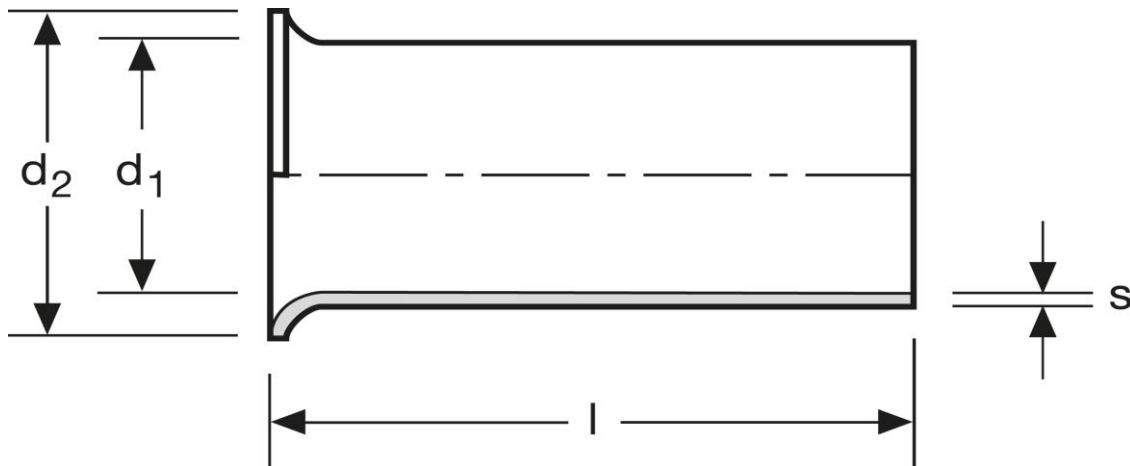

Art.Nr.	Werkstoff	Oberfläche		
A111120BL	Cu-ETP	keine	0,280/1000	500
	l	d_1	d_2	s
in mm:	12	3,6	4,7	0,20

Stand: 02.01.2018

Cord end-sleeves

6 mm² - 12 mm

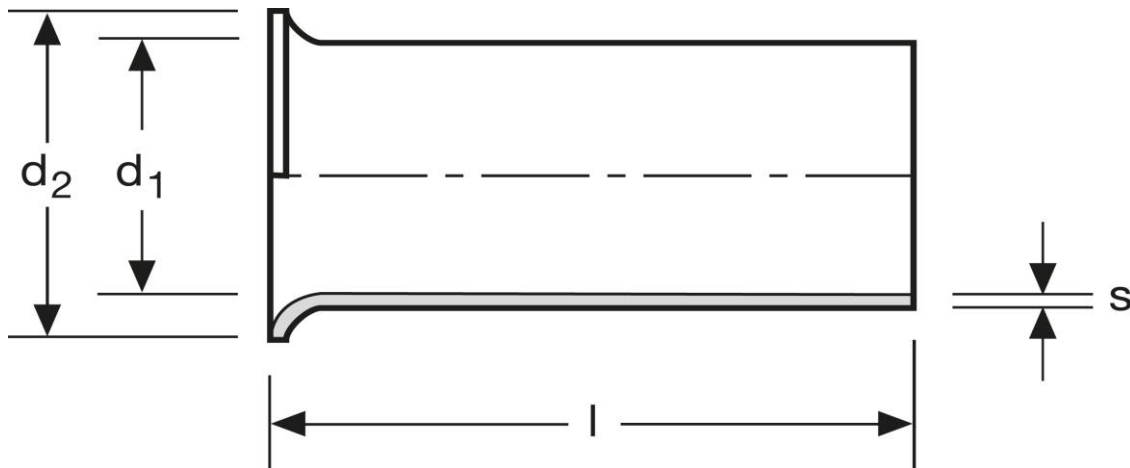

art.no.	material	surface		
A111120BL	Cu-ETP	none	0,280/1000	500
	l	d_1	d_2	s
in mm:	12	3,6	4,7	0,20

Date: 02.01.2018