

Aderendhülsen 25 mm² - 12 mm

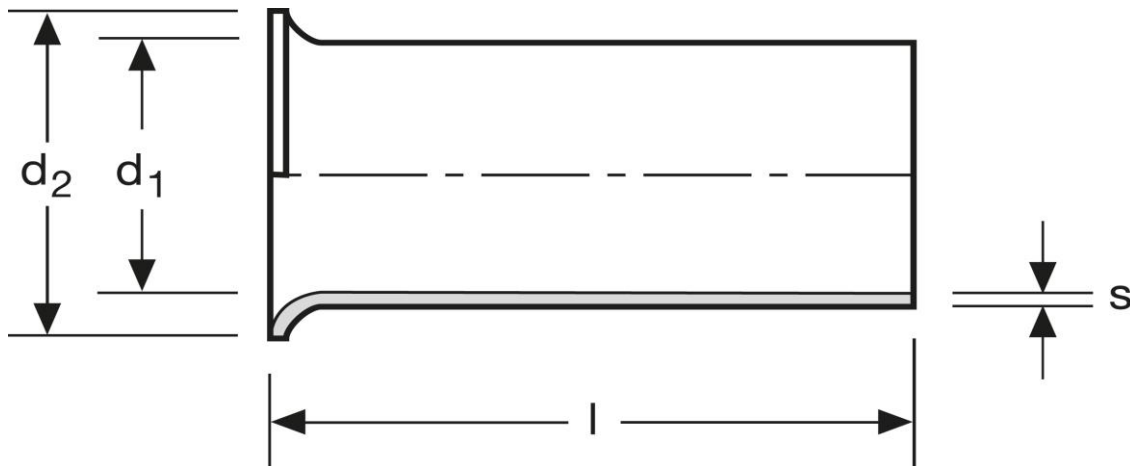

Art.Nr.	Werkstoff	Oberfläche		
A114120BL	Cu-ETP	keine	0,636/1000	100
	l	d ₁	d ₂	s
in mm:	12	7,4	9,5	0,22

Stand: 02.01.2018

Cord end-sleeves
 25 mm² - 12 mm

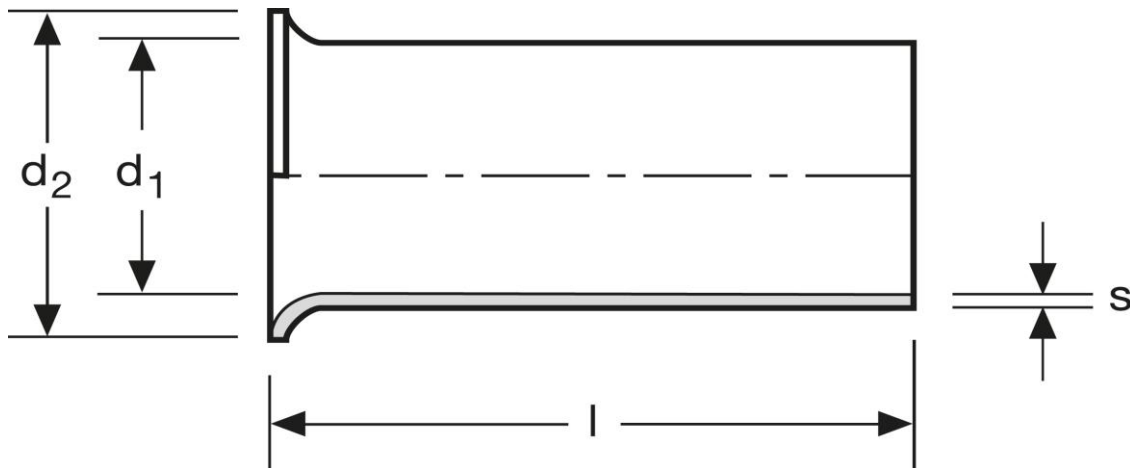

art.no.	material	surface		
A114120BL	Cu-ETP	none	0,636/1000	100
	l	d_1	d_2	s
in mm:	12	7,4	9,5	0,22

Date: 02.01.2018