

## Aderendhülsen 35 mm<sup>2</sup> - 18 mm

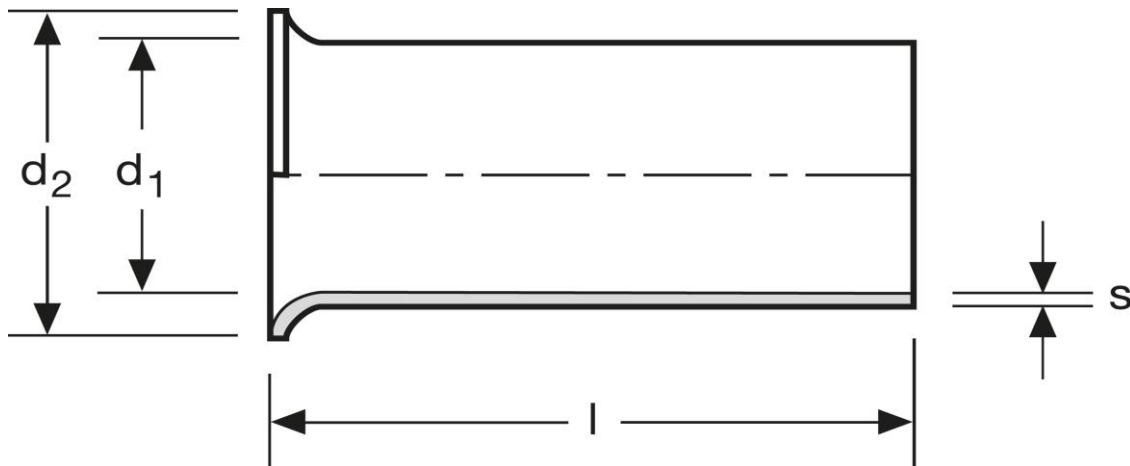

Art.Nr.	Werkstoff	Oberfläche		
A115180BL	Cu-ETP	keine	1,090/1000	100
	l	d <sub>1</sub>	d <sub>2</sub>	s
in mm:	18	8,4	11,0	0,23

Stand: 02.01.2018

**Cord end-sleeves**  
 35 mm<sup>2</sup> - 18 mm

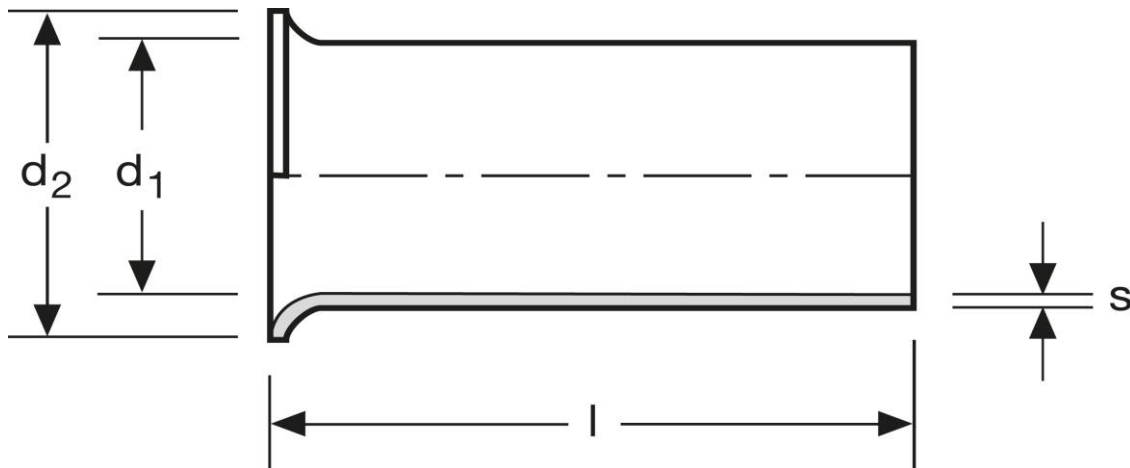

art.no.	material	surface		
A115180BL	Cu-ETP	none	1,090/1000	100
	$l$	$d_1$	$d_2$	$s$
in mm:	18	8,4	11,0	0,23

Date: 02.01.2018