

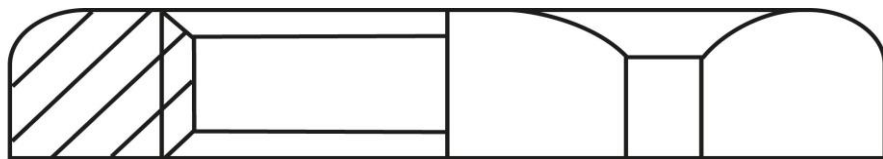

## Sechskantmuttern GM77

M 50 x 1,5

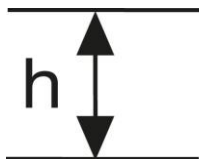



<b>Art. Nr.</b>	<b>Material</b>	<b>Oberfläche</b>	<b>Nenngröße</b>	
GM 877500	Messing	Nickel	M 50 x 1,5	50
	<b>h</b>		<b>Temperaturbereich</b>	
<b>in mm:</b>	5,0	60	- 60°C bis + 200°C	

Stand: 09.09.2019

## Hexagonal locknuts GM77

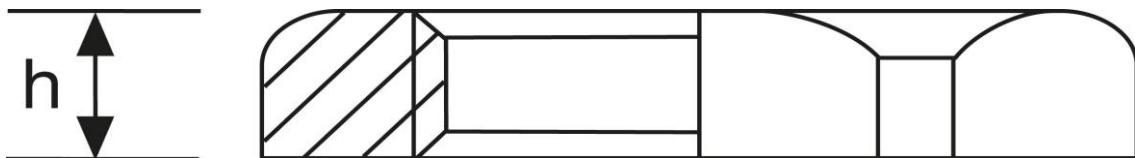
M 50 x 1,5



	<b>part no.</b>	<b>material</b>	<b>surface</b>	<b>nom. size</b>	
	GM 877500	brass	nickel	M 50 x 1,5	50
		<b>h</b>		<b>temperature range</b>	
<b>in mm:</b>		5,0	60	- 60°C up to + 200°C	

date: 09.09.2019