

Quetschkabelschuhe

Ringform

1,5 mm² M 2,5

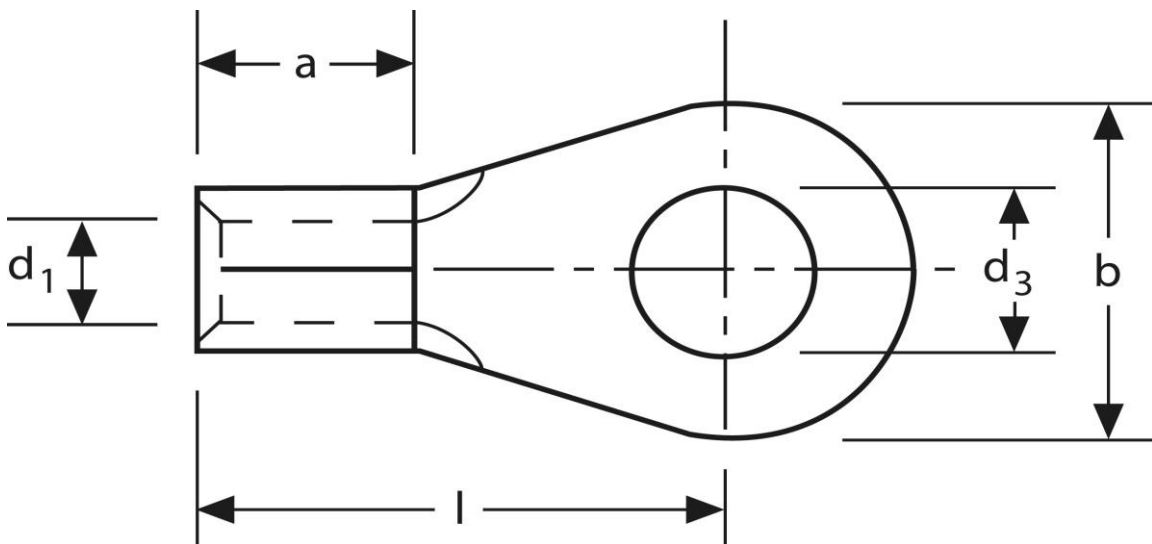

Art.Nr.	Werkstoff	Oberfläche		
K301025NTM	E-CU	galv. Sn	0,58 / 1000	1.000
	d ₃	d ₁	b	
in mm:	2,7	1,6	6	
	l	a		
in mm:	11	5		

Stand: 22.01.2019

Solderless terminals
ring-type
1,5 mm² M 2,5

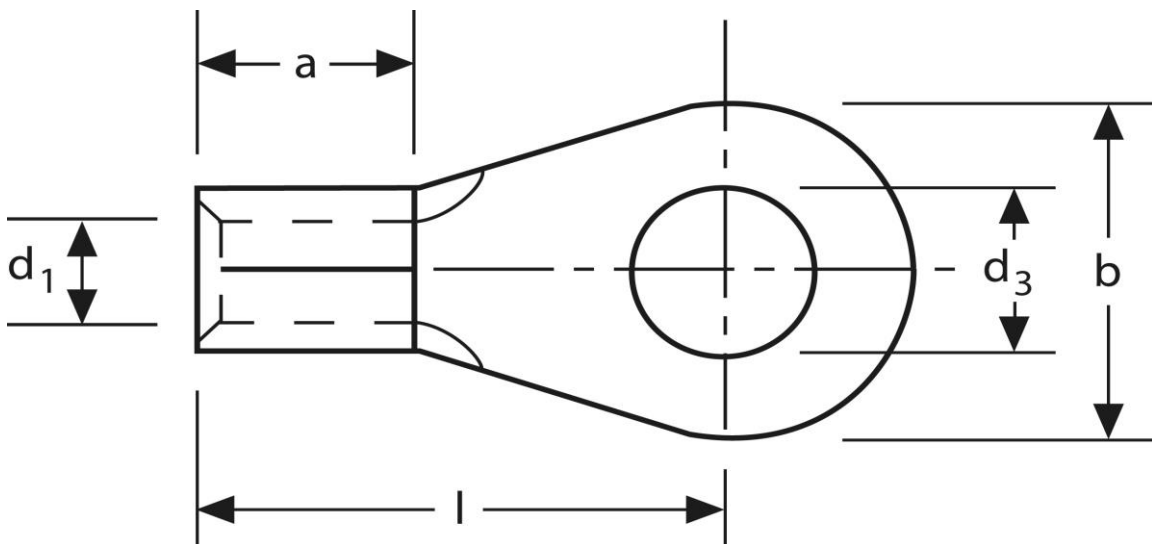

part no.	material	surface		
K301025NTM	E-CU	tin-plated	0,58 / 1000	1.000
	d₃	d₁	b	
in mm:	2,7	1,6	6	
	l	a		
in mm:	11	5		

date: 22.01.2019