

Quetschkabelschuhe
Ringform - Sonderausführung
16 mm² M 8

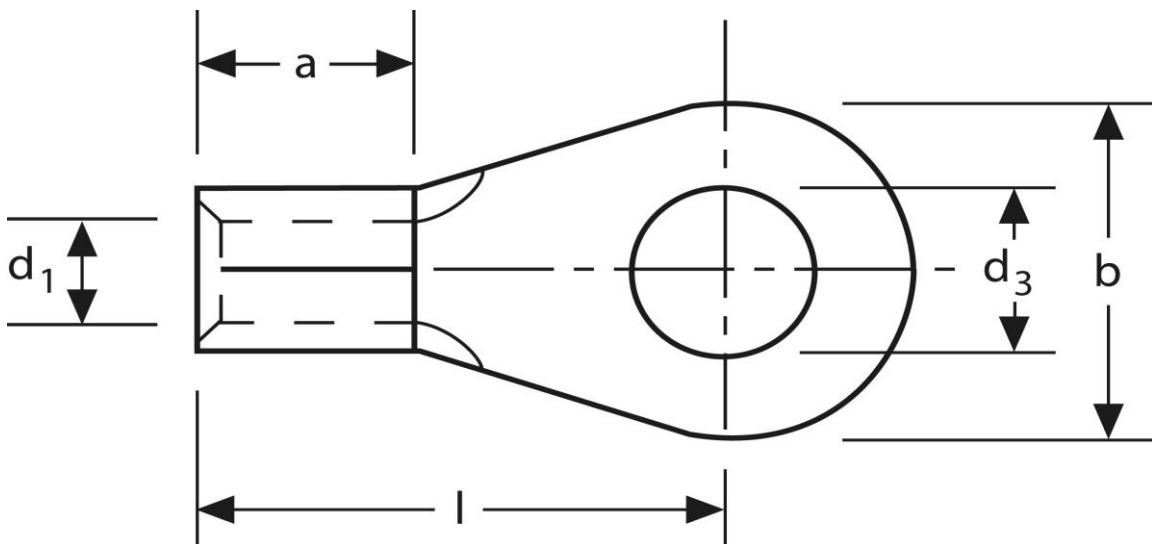

Art.Nr.	Werkstoff	Oberfläche		
K 305080.9	E-CU	galv. Sn	4,30 / 1000	500
	d ₃	d ₁	b	
in mm:	8,4	5,4	15	
	l	a	s	
in mm:	27	11,5	1,0	

Stand: 25.01.2019

Solderless terminals
ring-type
16 mm² M 8

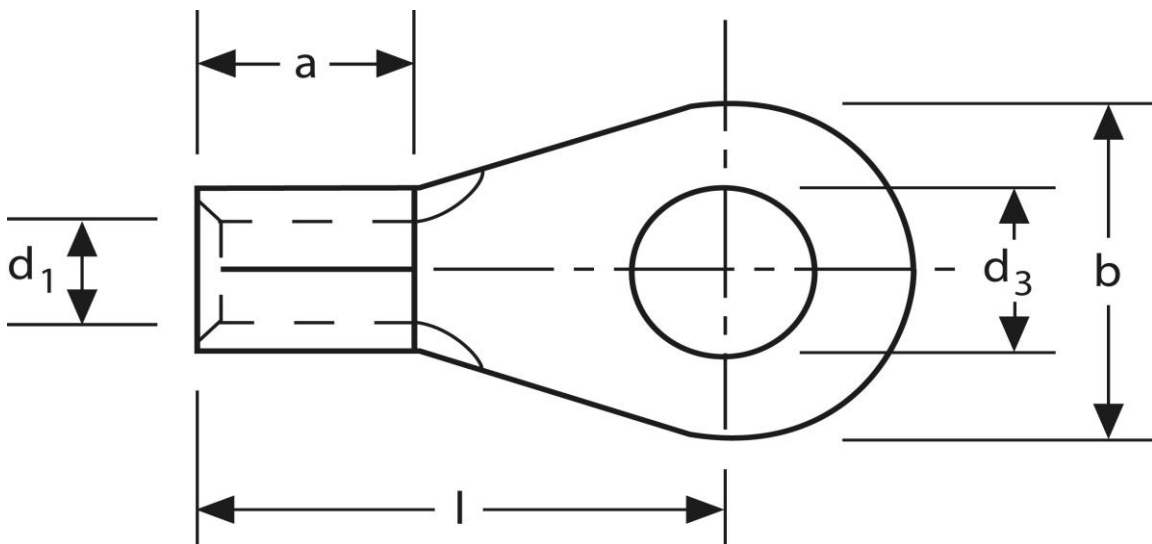

part no.	material	surface		
K 305080.9	E-CU	tin-plated	4,30 / 1000	500
	d₃	d₁	b	
in mm:	8,4	5,4	15	
	l	a	s	
in mm:	27	11,5	1,0	

date: 25.01.2019